

1-800-639-2199

Fax (603) 224-2927

Piers Rectangular 12 x 12 Inch Pier with Footing (v)

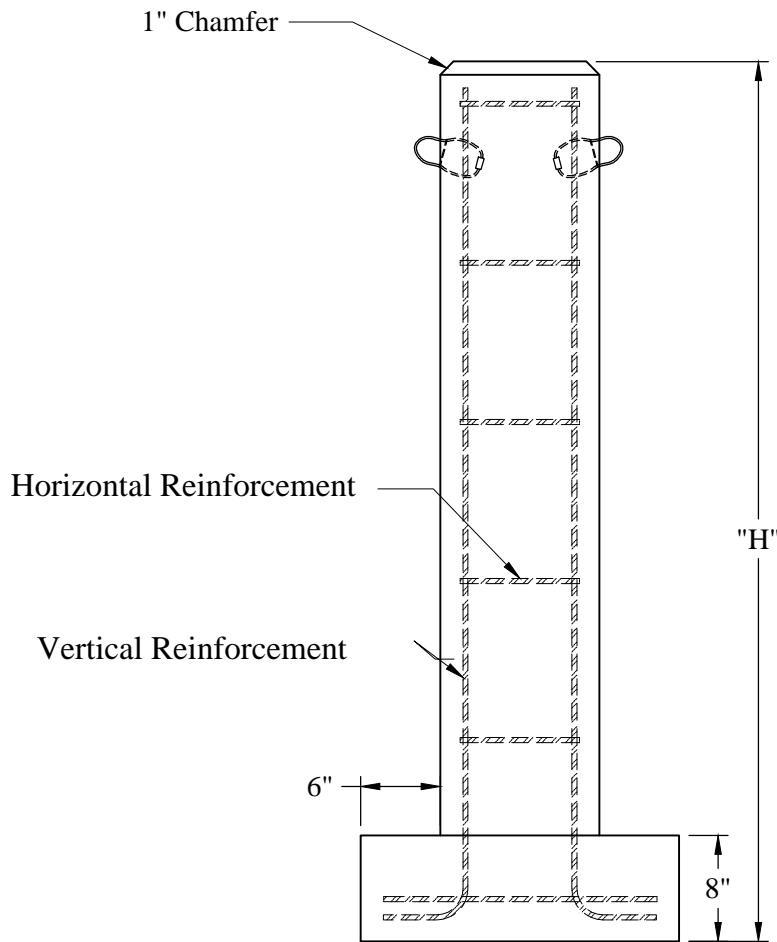
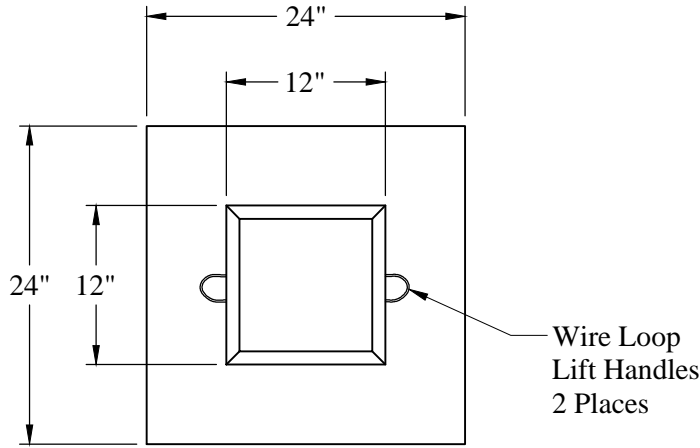

Height	Weight	P/N:
2'-8"	700 lbs	PIER-12S2F
3'-8"	850 lbs	PIER-12S3F
4'-8"	1,000 lbs	PIER-12S4F
5'-8"	1,150 lbs	PIER-12S5F
6'-8"	1,300 lbs	PIER-12S6F

**General Notes**

1. Concrete:  $f_c = 4,000$  PSI @ 28 Days Minimum
2. Reinforcing Steel Conforms to Latest ASTM Specifications:  
ASTM A615 Grade 60 Rebar Black Deformed Bars

Phoenix  
Precast  
Products

12" x 12" Pier  
With Footing

Phoenix Precast Products

Phoenix Precast Products